



Pro

Easy Lift, Easy Life!

The new-generation SINOLIFT L series PRO forklift truck with a capacity of 2.0–3.8 tons has just been released. This new series offers not only environmentally friendly design, but also operator friendly maneuverability and builds on the outstanding performance of the previous series, which was well received in the lift truck market. The new series closely resembles our highly acclaimed 2-3.8 tons IC forklift trucks.

High Efficiency and Productivity

- Faster lifting & lowering speed
- Precisely steering
- Higher acceleration ability
- New brake system

Comfort and Ergonomics

- Smaller steering wheel
- Ergonomics designed operation handler
- Excellent visibility
- Low vibration & noise level
- Enlarged operation space
- Multifunctional LCD display meter

Safety Operation

- Low truck gravity
- Integral heavy duty chassis
- System of active stability

Superior and Economic Serviceability

- Newly designed engine cover structure
- Easy service and maintenance design
- Unique design of radiator assembly
- Reliable hydraulic system



SHANGHAI SINOLIFT MECHANICAL AND ELECTRICAL EQUIPMENT CO.,LTD.

Address: No. 2471 Dachuan Road, Nanhui Industry Park, Pudong New District, Shanghai, 201399,P.R.China

Tel: 0086-21-68014500 or 0086-21-58003681

Fax: 0086-21-68014262

Website: www.sinolift.com www.sinolifttruck.com

Wechat: sinoliftdeng

Whatsapp & Mobile: 0086 138 1757 2420



Sinolift – For material handling

The L series PRO are the new series of internal combustion counterbalance forklift truck developed by Sinolift independently, adopting the world advanced technologies based on the original products. Through the comprehensive upgrading of appearance molding, energy conservation, environmental friendly, comfort, security and reliability, it will become the world-class forklift truck which can meet your overall demands.



► Small steering wheel

Ergonomically designed tilt angle adjustable small diameter steering wheel (φ300) with good feel and reduced operator fatigue intensity.



► Intelligentize

According to the advanced ergonomic design, integrated control valve type operating handle, electrical switches centralized layout, fast and convenient manipulation.



► Stamped hood

Adopting pressed hood, the whole vehicle is more solid and reliable.



► Central electric box

Electrical wiring integrated design, fuses and relays centralized in the electrical box. Spare fuse is inside the hood, with waterproof and dustproof effect, reliable plugging and convenient maintenance.



► Quanchai engine

Selected Quanchai high-pressure common rail engine, strong power, guaranteed quality, cleaner emissions, more efficient fuel.



► Two-stage air purification

Iron air filter and intake high independent channel two-stage air purification design makes the diesel fuel burn more fully and extends the engine life.



► Side roller wheel

The side roller is above the main roller. When the shelf is raised to a higher position, the left-right shaking amplitude is greatly reduced, which improves the stability of high position operation and reduces the bearing failure rate.



► Digital dashboard

Using digital stepping instrument panel and CAN bus communication technology, display more intuitive, high man-machine interaction, real-time monitoring of the state of the machine.

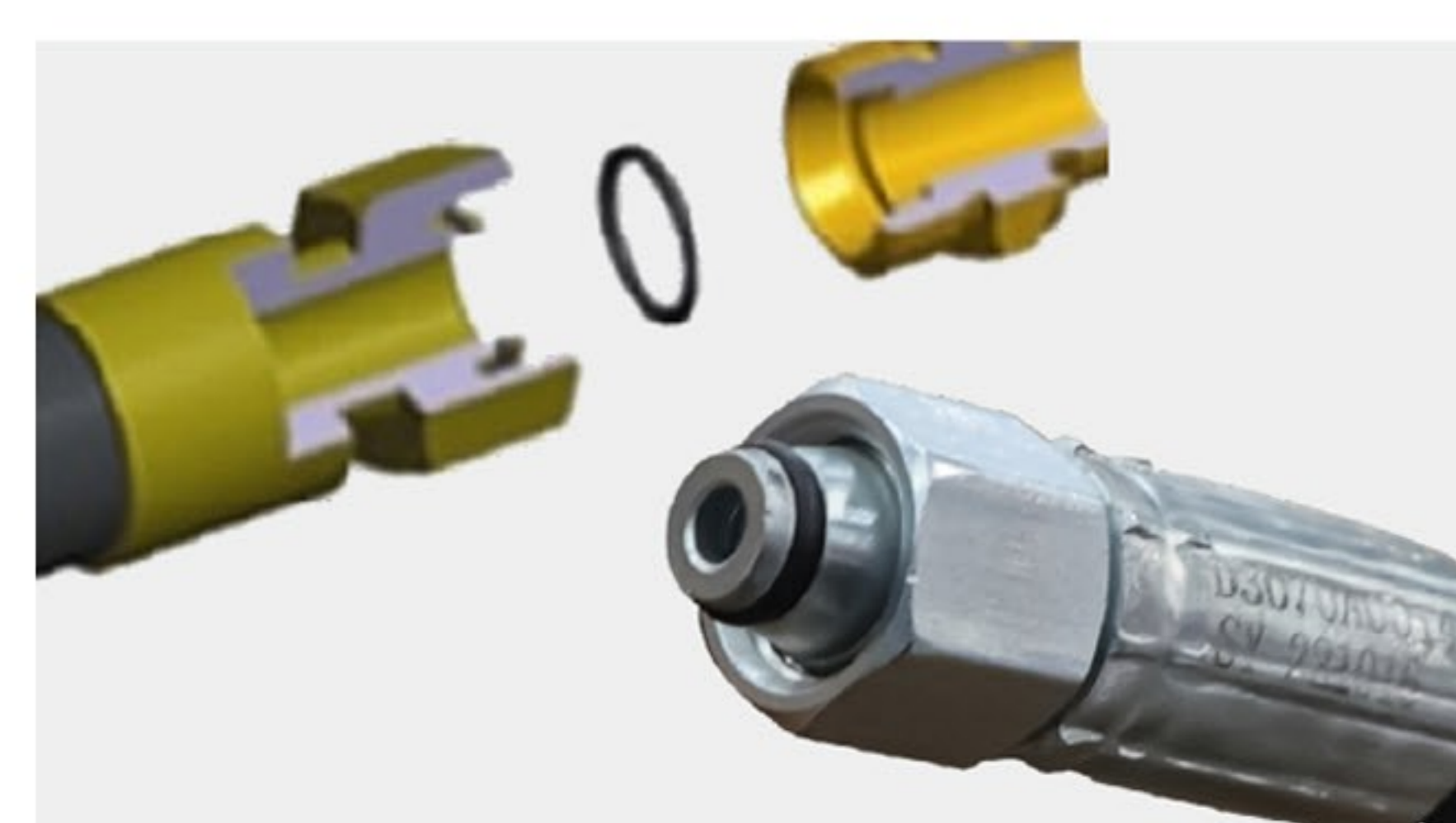

► Hydraulic system

Hydraulic system for engineering vehicle level, the whole vehicle hydraulic pipeline is 24° cone seal. Hydraulic cylinder and oil circuit optimization design, cargo lifting speed increased by 15%, more powerful overload capacity.



► Large opening hood

Optimize the layout of the engine room, the battery, oil pump motor, electrical components, hydraulic fuel tank are all in the engine room, the hood opening angle is large, daily maintenance is more convenient.



► Maintenance free steering axle

Casting integral steering axle, spindle bearing using tapered bearing design for better impact resistance and long service life. Body contact parts are installed with buffer blocks to improve comfort and reduce fatigue.



► Increase space

Increase the leg operating space and reduce the height of the pedal. Anti-slip pedal and welded handle for safe and convenient boarding.

► Ultra high technology

The coating of the overhead guard frame adopts electrophoresis process, robot welding, solid welding seam, the whole machine is more stable and reliable.

► Body appearance

Sinolift appearance design, sheet metal mold once formed, the lines are not only smooth and beautiful, better anti-collision and anti-deformation performance. Surface pickling phosphating rust removal, baking paint process, anti-corrosion, rust, anti-oxidation effect, the later higher value retention.

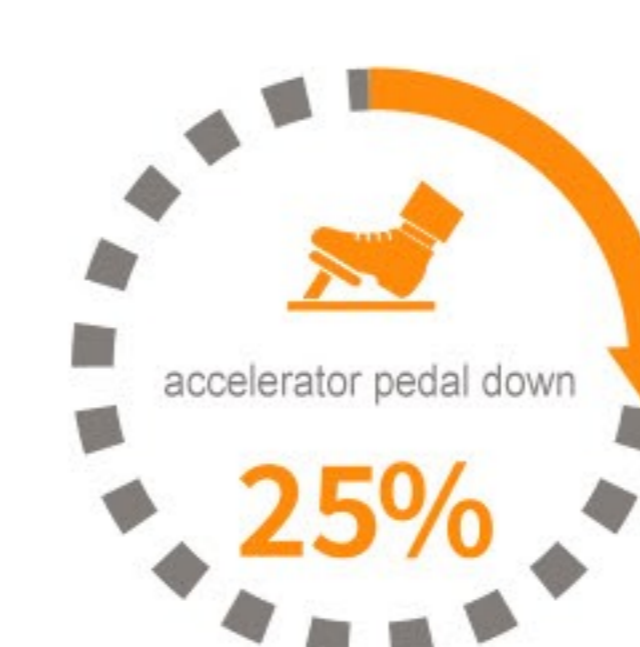
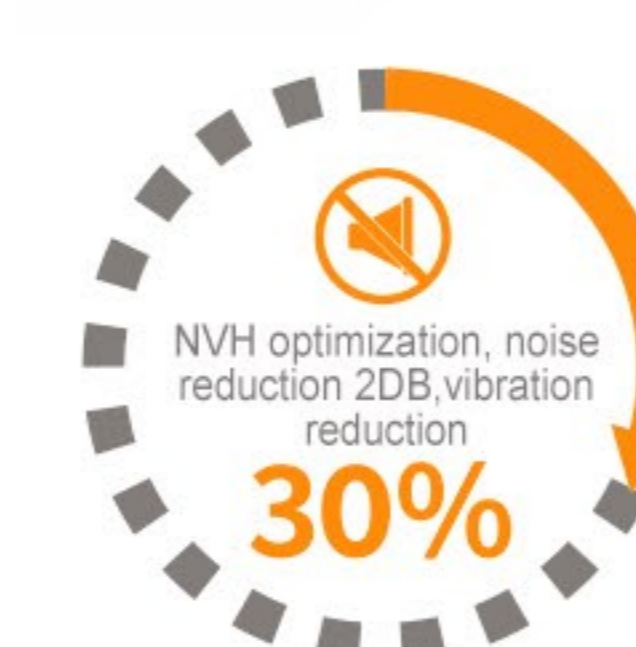
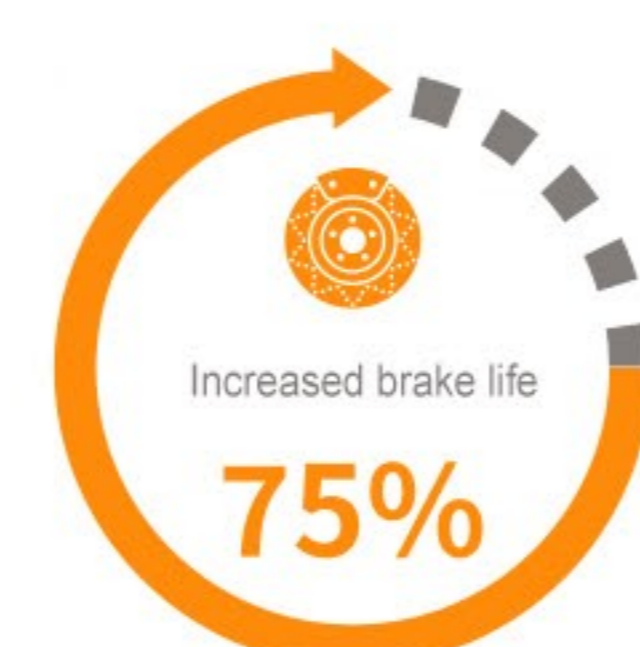
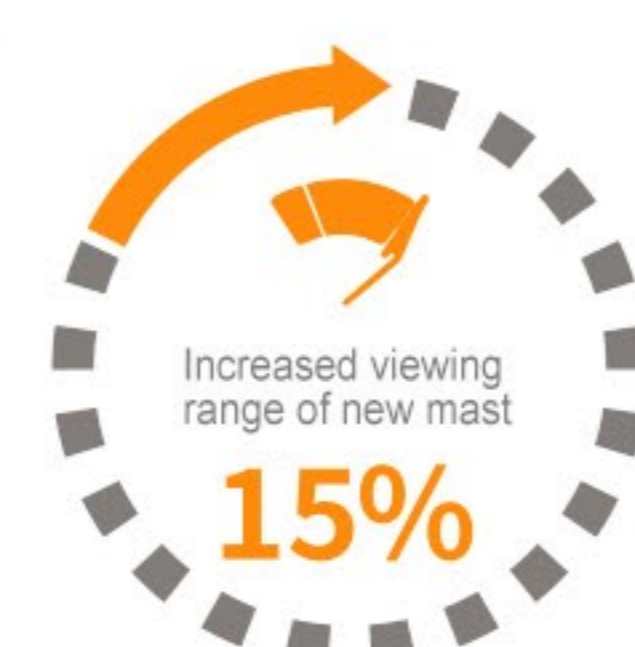
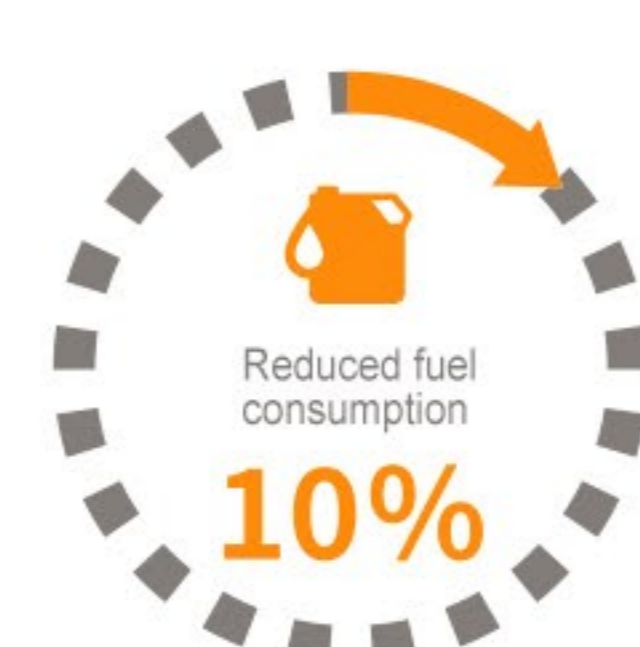
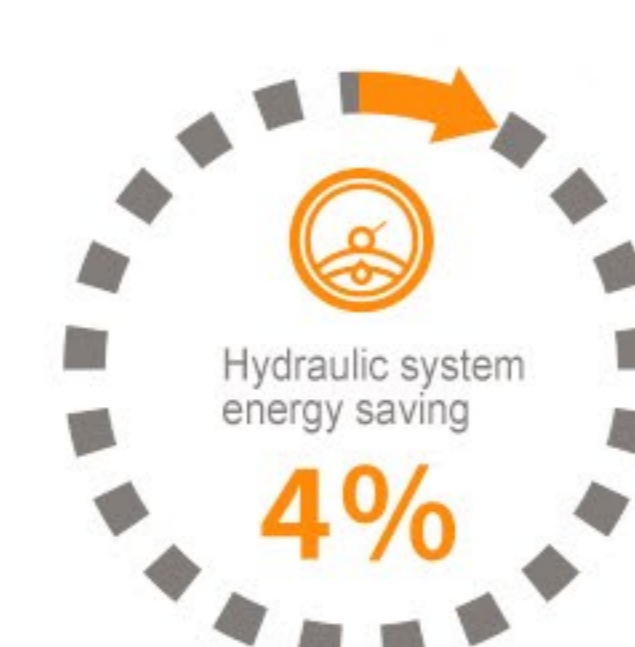

SINOLIFT

Manufacturer Brand			SINOLIFT										
Model			CPCD20L+	CP(C)D25L+	CP(C)D30L+	CP(C)D35L+	CP(C)D38L+	CP(Q)YD20L+	CP(Q)YD25L+	CP(Q)YD30L+	CP(Q)YD35L+	CP(Q)YD38L+	
Power type			Diesel					Gas/LPG					
Rated capacity	Q	kg	2000	2500	3000	3500	3800	2000	2500	3000	3500	3800	
Load center	C	mm	500	500	500	500	500	500	500	500	500	500	
Lift height	H	mm	3000	3000	3000	3000	3000	3000	3000	3000	3000	3000	
Free lift height	H5	mm	130	130	130	130	130	130	130	130	130	130	
Fork size	Min./Max.	LxWxT	mm	1070x120x40	1070x120x40	1070x122x45	1070x122x50	1070x122x50	1070x120x40	1070x120x40	1070x122x45	1070x122x50	1070x122x50
Fork spread outside	W5	mm	240/1024	240/1024	244/1060	244/1060	244/1060	240/1024	240/1024	244/1060	244/1060	244/1060	
Mast tilt angle	α/β	deg	6°/12°	6°/12°	6°/12°	6°/12°	6°/12°	6°/12°	6°/12°	6°/12°	6°/12°	6°/12°	
Front overhang	L2	mm	462	462	475	480	490	462	462	475	480	490	
Rear overhang	L3	mm	408	408	600	600	600	408	408	600	600	600	
Overall dimensions	Length to face of fork	L'	mm	2520	2520	2825	2880	2990	2520	2520	2825	2880	2990
	Overall width	W1	mm	1170	1170	1230	1230	1230	1170	1170	1230	1230	1230
	Height of load backrest	H6	mm	965	965	1225	1225	1225	965	965	1225	1225	1225
	Mast lowered height	H1	mm	2000	2000	2130	2130	2130	2000	2000	2130	2130	2130
	Mast extended height	H2	mm	4035	4035	4230	4230	4230	4035	4035	4230	4230	4230
Overhead guard height	H3	mm	2110	2110	2145	2145	2145	2110	2110	2145	2145	2145	
Turning radius	r	mm	2290	2290	2560	2620	2720	2290	2290	2560	2620	2720	
Performance	No load/full load	Travel speed	km/h	17/19	17/19	18.5/19	18.5/19	18.5/19	17/19	17/19	18.5/19	18.5/19	18.5/19
		Lift speed	mm/sec	540/450	540/450	450/410	450/410	330/310	540/450	540/450	450/410	450/410	330/310
		Lowering speed	mm/sec	560/600	560/600	455/480	455/480	370/400	560/600	560/600	455/480	455/480	370/400
Max. gradeability (full load /no load)		%	15/20	15/20	15/20	15/20	15/20	15/20	15/20	15/20	15/20	15/20	
Max. drawbar pull		KN	16	16.5	20	20	20	16	16.5	20	20	20	
Self weight		kg	3400	3700	4300	4600	4800	3400	3700	4300	4600	4800	
Wheel & Tire	Tires	Front		7.00-12-12PR	7.00-12-12PR	28x9-15-14PR	28x9-15-14PR	28x9-15-14PR	7.00-12-12PR	7.00-12-12PR	28x9-15-14PR	28x9-15-14PR	28x9-15-14PR
		Rear		6.00-9-10PR	6.00-9-10PR	6.50-10-10PR	6.50-10-10PR	6.50-10-10PR	6.00-9-10PR	6.00-9-10PR	6.50-10-10PR	6.50-10-10PR	6.50-10-10PR
	Tread	Front	W1	mm	970	970	1000	1000	1000	970	970	1000	1000
		Rear	W2	mm	980	980	970	970	970	980	980	970	970
Wheelbase	L1	mm	1650	1650	1750	1800	1900	1650	1650	1750	1800	1900	
Min. ground clearance	H5	mm	110	110	130	130	130	110	110	130	130	130	
Operating pressure		Mpa	17.5	17.5	17.5	17.5	17.5	17.5	17.5	17.5	17.5	17.5	
Battery		V/AH	12/80	12/80	12/80	12/80	12/80	12/80	12/80	12/80	12/80	12/80	
Drive units & control	Engine	Model		Xinchai C490BPG	Quanchai V29-50C43	Isuzu C240PKJ-30	Xinchai A495BPG	Isuzu 4JG2PE-01	Guangqing GQ-4Y	Nissan GK21	Nissan GK25	PSI 2.4	Kubota WG2503-GL-3
		Rated output	kw/rpm	36.8/2650	36.8/2500	34.6/2500	42/2500	46/2450	46/2800 (GAS) 39/2800 (LPG)	31.2/2250 (GAS) 29/2250 (LPG)	37.4/2300 (GAS) 35/2300 (LPG)	48/2700 (GAS) 46/2700 (LPG)	42.8/2600 (GAS) 43.5/2600 (LPG)
		Rated torque	N.m/rpm	156/1700-1900	190/1500-1850	139.2/1800	174/1800-2000	186/1700-1800	168/1800 (GAS) 156/1800 (LPG)	143.7/1600 (GAS) 143/1600 (LPG)	176.5/1600 (GAS) 176/1600 (LPG)	170/2400 (GAS) 168/1600 (LPG)	163.3/1800 (GAS) 173.7/1400 (LPG)
		No. of cylinder		4	4	4	4	4	4	4	4	4	4
		Bore x stroke	mm	90x105	93x105	86x102	95x105	95.4x107	91x86	89x83	89x100	86.5x100	88x102.4
		Displacement	cc	2670	2850	2369	2977	3059	2237	2065	2488	2351	2491
		Emission standard		Stage II/EUR III	Stage IV	Stage II/EURO IIIA	Stage II	Stage II/EURO IIIA	Stage II	Stage II	Stage II	Stage II	EPA T4
Type			Mechanical/Hydraulic										
Hydraulic system working pressure		MpA	17.5	17.5	17.5	17.5	17.5	17.5	17.5	17.5	17.5	17.5	

LOAD CURVE

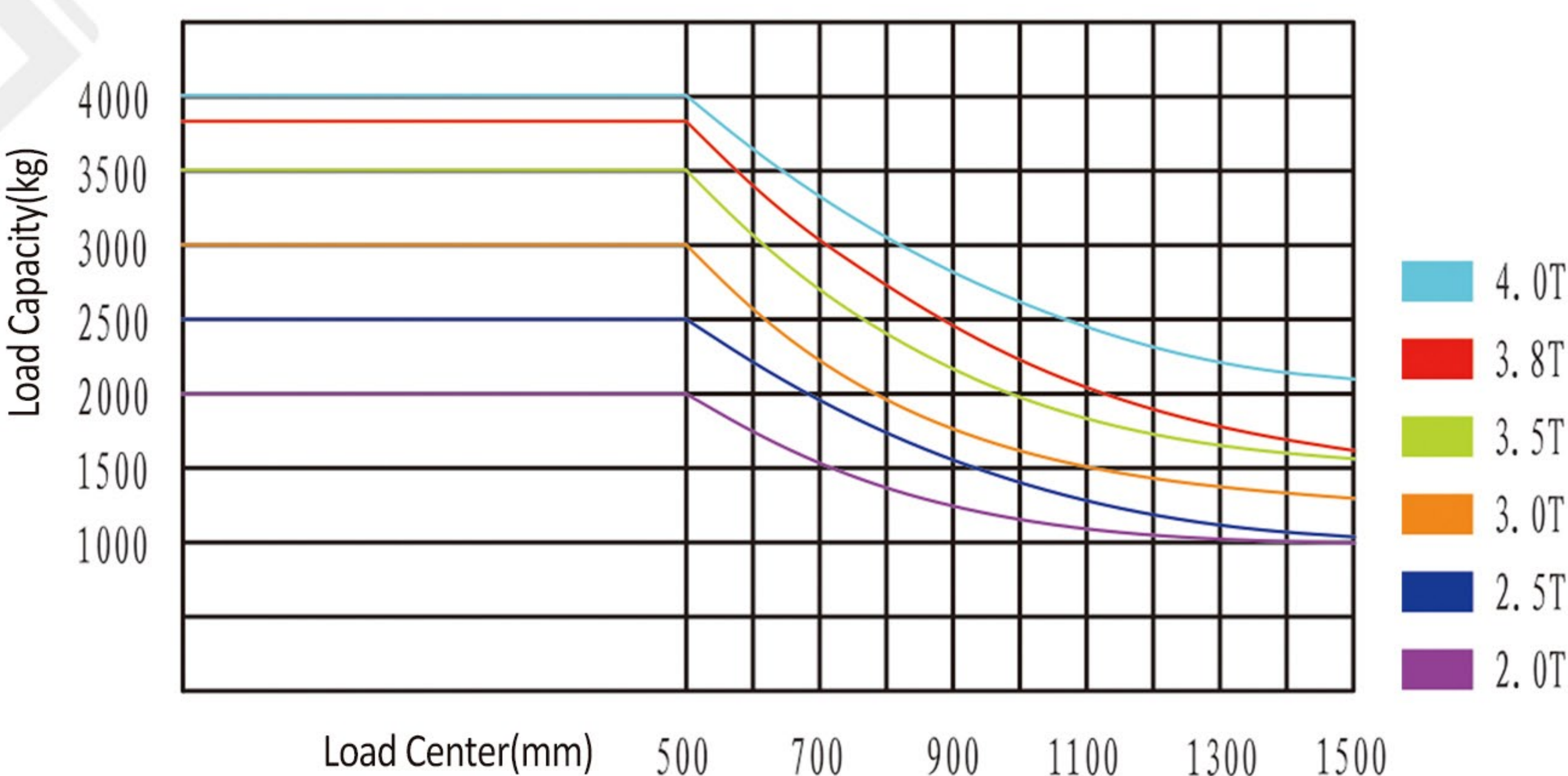

Note: The vertical axis represents the load capacity, and the horizontal axis represents the load center. The load center is calculated from the front of the fork. The reference point for the standard load is the center position of a cube with a load length of 1000 mm. When the mast is inclined forward, using non-standard forks, or loading loads wider than the normal width, the load capacity will decrease. Through the load curve diagram, one can promptly understand the load capacity of various load centers.

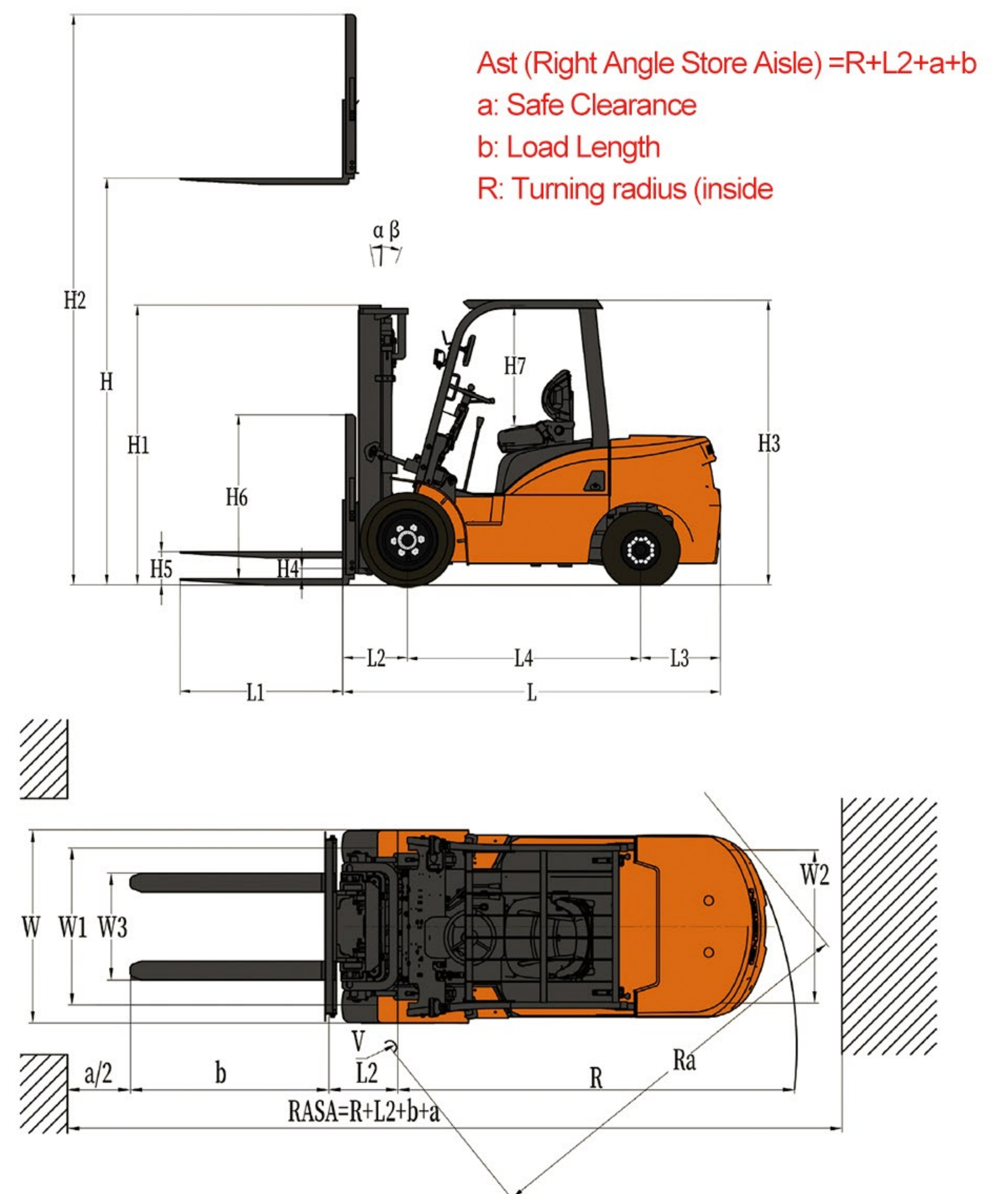

Mast size of 2-3.8T L series PRO internal-combustion counter balanced forklift

2-Stage wide view duplex mast

Mast Model	Lifting Height	Mast Height										Free Lift Height					Mast Tilt Angle			Rated Load Capacity					
		Retracted Mast Height					Height, with Mast Extended					With Backrest					Forward/Backward			Load Center 500mm					
		2t	2.5t	3t	3.5t	3.8t	2t	2.5t	3t	3.5t	3.8t	2t	2.5t	3t	3.5t	3.8t	2/2.5t	3/3.5t	3.8t	2t	2.5t	3t	3.5t	3.8t	
		H1					H2					H5					α/β			Q					
mm	mm	mm	mm	mm	mm	mm	mm	mm	mm	mm	mm	mm	mm	mm	mm	mm	mm	(°)	(°)	(°)	(kg)	(kg)	(kg)	(kg)	(kg)
2M200	2000	1495	1495	1570	1625	1625	3005	3005	3185	3185	3185	135	135	135	140	145	6°/12°	6°/12°	6°/12°	2000	2500	3000	3500	3800	
2M250	2500	1745	1745	1820	1875	1875	3505	3505	3685	3685	3685	135	135	135	140	145	6°/12°	6°/12°	6°/12°	2000	2500	3000	3500	3800	
2M270	2700	1845	1845	1920	1975	1975	3705	3705	3885	3885	3885	135	135	135	140	145	6°/12°	6°/12°	6°/12°	2000	2500	3000	3500	3800	
2M300	3000	1995	1995	2070	2125	2125	4005	4005	4185	4185	4185	135	135	135	140	145	6°/12°	6°/12°	6°/12°	2000	2500	3000	3500	3800	
2M330	3300	2145	2145	2220	2275	2275	4305	4305	4485	4485	4485	135	135	135	140	145	6°/12°	6°/12°	6°/12°	2000	2500	3000	3500	3800	
2M350	3500	2245	2245	2320	2375	2375	4505	4505	4685	4685	4685	135	135	135	140	145	6°/12°	6°/12°	6°/12°	2000	2500	3000	3500	3800	
2M360	3600	/	/	2370	2425	/	/	/	4785	4785	/	/	/	135	140	/	/	6°/12°	6°/12°	/	/	/	3000	3500	/
2M370	3700	2345	2345	2420	2475	2475	4705	4705	4885	4885	4885	135	135	135	140	145	6°/12°	6°/12°	6°/12°	2000	2500	3000	3500	3800	
2M380	3800	/	/	2470	2525	2525	/	/	4985	4985	4985	/	/	135	140	145	/	6°/12°	6°/12°	/	/	/	3000	3500	3600
2M400	4000	2545	2545	2620	2675	2675	5105	5105	5185	5185	5185	135	135	135	140	145	6°/12°	6°/12°	6°/12°	2000	2500	3000	3200*3500	3700	
2M425	4250	2670	2670	2745	2800	2800	5355	5355	5435	5435	5435	135	135	135	140	145	6°/8°	6°/8°	6°/8°	1900*2000	2250*2500	2850*3000	3100*3200	3550*3650	
2M450	4500	2795	2795	2870	2925	2925	5605	5605	5685	5685	5685	135	135	135	140	145	6°/8°	6°/8°	6°/8°	1800*1900	2150*2400	2750*3000	3000*3050	3400*3600	
2M475	4750	2920	2920	2995	3050	3050	5855	5855	5935	5935	5935	135	135	135	140	145	6°/8°	6°/8°	6°/8°	1700*1800	1900*2300	2600*2950	2800*3000	3200*3400	
2M500	5000	3045	3045	3120	3175	3175	6105	6105	6185	6185	6185	135	135	135	140	145	6°/8°	6°/8°	6°/8°	1600*1700	1650*2200	2400*2850	2500*2850	3000*3200	
2M550	5500	3345	3345	3420	3475	3475	6705	6705	6685	6685	6685	135	135	135	140	145	6°/8°	6°/8°	6°/8°	*1600	*1950	*2400	*2500	2700*3000	
2M600	6000	3595	3595	3670	3725	3725	7205	7205	7185	7185	7185	135	135	135	140	145	3°/6°	3°/6°	3°/6°	*1500	*1800	*2200	*2300	2200*2600	

Note: ① The lifting weight is reduced by 100KG when equipped with built-in side shifter, and 200KG when equipped with external side shifter

2-Stage full free lift mast

Mast Model	Lifting Height	Mast Height										Free Lift Height					Mast Tilt Angle			Rated Load Capacity					
		Retracted Mast Height					Height, with Mast Extended					With Backrest					Forward/Backward			Load Center 500mm					
		2t	2.5t	3t	3.5t	3.8t	2t	2.5t	3t	3.5t	3.8t	2t	2.5t	3t	3.5t	3.8t	2/2.5t	3/3.5t	3.8t	2t	2.5t	3t	3.5t	3.8t	
		H1					H2					H5					α/β			Q					
mm	mm	mm	mm	mm	mm	mm	mm	mm	mm	mm	mm	mm	mm	mm	mm	mm	mm	(°)	(°)	(°)	(kg)	(kg)	(kg)	(kg)	(kg)
2FFM200	2000	1495	1495	1625	1625	1625	3005	3005	3175	3175	3175	530	530	485	490	490	6°/12°	6°/12°	6°/12°	2000	2500	3000	3500	3800	
2FFM225	2250	1620	1620	1750	1750	1750	3255	3255	3425	3425	3425	655	655	610	615	615	6°/12°	6°/12°	6°/12°	2000	2500	3000	3500	3800	
2FFM250	2500	1745	1745	1875	1875	1875	3505	3505	3675	3675	3675	780	780	735	740	740	6°/12°	6°/12°	6°/12°	2000	2500	3000	3500	3800	
2FFM270	2700	1845	1845	1975	1975	1975	3705	3705	3875	3875	3875	880	880	835	840	840	6°/12°	6°/12°	6°/12°	2000	2500	3000	3500	3800	
2FFM300	3000	1995	1995	2125	2125	2125	4005	4005	4175	4175	4175	1030	1030	985	990	990	6°/12°	6°/12°	6°/12°	2000	2500	3000	3500	3800	
2FFM330	3300	2145	2145	2275	2275	2275	4310	4310	4475	4475	4475	1180	1180	1135	1140	1140	6°/12°	6°/12°	6°/12°	2000	2500	3000	3500	3800	
2FFM350	3500	2245	2245	2375	2375	2375	4505	4505	4675	4675	4675	1280	1280	1235	1240	1240	6°/12°	6°/12°	6°/12°	2000	2500	3000	3500	3800	
2FFM370	3700	2345	2345	2475	2475	2475	4705	4705	4875	4875	4875	1380	1380	1335	1340	1340	6°/12°	6°/12°	6°/12°	2000	2500	3000	3500	3800	
2FFM400	4000	2545	2545	2675	2675	2675	5005	5005	5175	5175	5175	1580	1580	1535	1540	1540	6°/12°	6°/12°	6°/12°	2000	2500	3000	3200*3500	3700	

Note: (1) The lifting weight is reduced by 100kg when equipped with built-in side shifter, and 200kg when equipped with external side shifter. (2) * refers to the rated load capacity of double tyres for front wheels.
(3) 2-2.5T: the free lifting height increases by 335mm without backrest. 3-3.8T: the free lifting height increases by 400mm

3-Stage full free lift mast

Mast Model	Lifting Height	Mast Height										Free Lift Height					Mast Tilt Angle			Rated Load Capacity					
		Retracted Mast Height					Height, with Mast Extended					With Backrest					Forward/Backward			Load Center 500mm					
		2t	2.5t	3t	3.5t	3.8t	2t	2.5t	3t	3.5t	3.8t	2t	2.5t	3t	3.5t	3.8t	2/2.5t	3/3.5t	3.8t	2t	2.5t	3t	3.5t	3.8t	
		H1					H2					H5					α/β			Q					
mm	mm	mm	mm	mm	mm	mm	mm	mm	mm	mm	mm	mm	mm	mm	mm	mm	mm	(°)	(°)	(°)	(kg)	(kg)	(kg)	(kg)	(kg)
3FFM290	2900	/	/	1635	1635	/	/	/	4085	4085	/	/	/	495	500	/	/	6°/8°	6°/8°	/	/	2900	3350	/	
3FFM320	3200	/	/	/	/	1735	/	/	/	/	4385	/	/	/	/	600	/	6°/8°	6°/8°	/	/	/	/	3800	
3FFM360	3600	1845	1845	1870	1870	1870	4605	4605	4785	4785	4785	880	880	730	735	735	6°/8°	6°/8°	6°/8°	2000	2400	2900	3250	3800	
3FFM400	4000	1995	1995	2020	2020	1995	5005	5005	5185	5185	5185	1030	1030	880	885	860	6°/8°	6°/8°	6°/8°	1900	2400	2900	3250	3700	
3FFM435	4350	2095	2095	2120	2120	2125	5355	5355	5535	5535	5535	1130	1130	980	985	990	6°/8°	6°/8°	6°/8°	1850*1900	2200*2400	2850*2900	2900*3050	3500*3600	
3FFM450	4500	2145	2145	2170	2170	2170	5505	5505	5685	5685	5685	1180	1180	1030	1035	1035	6°/8°	6°/8°	6°/8°	1750*1800	2150*2300	2750*2850	2800*2950	3400*3600	
3FFM470	4700	2210	2210	2230	2230	2235	5700	5700	5885	5885	5885	1245	1245	1090	1095	1100	6°/8°	6°/8°	6°/8°	1720*1800	2000*2300	2650*2800	2700*2900	3100*3200	
3FFM480	4800	2245	2245	2270	2270	2270	5805	5805	5985	5985	5985	1290	1290	1130	1135	1135	6°/8°	6°/8°	6°/8°	1700*1800	1950*2300	2550*2800	2650*2900"	3100*3200	
3FFM500	5000	2345	2345	2370	2370	2370	6005	6005	6185	6185	6185	1380	1380	1230	1235	1235	6°/8°	6°/8°	6°/8°	1600*1750	1650*2250	2450*2750	2500*2850"	3000*3150	
3FFM540	5400	2445	2445	2470	2470	2495	6405	6405	6585	6585	6585	1480	1480	1330	1335	1360	6°/8°	6°/8°	6°/8°	1450*1700	1500*2150	2300*2650	2350*2700"	2700*3000	
3FFM550	5500	/	/	2505	2505	/	/	/	6690	6690	/	/	/	/	/	/	/	6°/8°	6°/8°	/	/	2200*2400	2250*2450"	/	
3FFM600	6000	2645	2645	2670	2670	2720	7005	7005	7185	7185	7185	1680	1680	2530	1535	1585	3°/6°	3°/6°	3°/6°	*1600	*1800	*2100	*2250	2200*2600	
3FFM620	6200	/	/	/	/	2770	/	/	/	/	7385	/	/	/	/	/	/	3°/6°	3°/6°	/	/	/	/	1800*2400	
3FFM650	6500	2845	2845	2870	2870	2910	7505	7505	7685	7685	7685	1880	1880	1730	1735	1775	3°/6°	3°/6°	3°/6°	*1450	*1650	*1900	*2200	1500*2500	
3FFM700	7000	3020	3020	3045	3045	3180	8015	8015	8180	8180	8185	2055	2055	1905	1910	2045	3°/3°	3°/3°	3°/3°	*1150	*1300	*1800	*2000	*2200	
3FFM750	7500	3195	3195	3370	3370	3365	8505	8505	8685	8685	8685	2230	2230	2230	2235	2230	3°/3°	3°/3°	3°/3°	*950	*1050	*1200	*1300	/	

Note: (1) The lifting weight is reduced by 100kg when equipped with built-in side shifter, and 200kg when equipped with external side shifter;
(2) * refers to the rated load capacity of double tyres for front wheels. (3) 2-2.5T: the free lifting height increases by 315mm without backrest. 3-3.8T: the free lifting height increases by 415mm

▶ Speed limiter (optional)

▶ Enhanced Operator Presence System with comprehensive security upgrade

Walking on site induction safety system

When the machine is running, the operator will suddenly leave the correct operating position without releasing the accelerator pedal, and the power will be cut off to protect the safety of running.

LHS (Load Handling System) on site induction safety system and reset control system

When the operator leaves or returns to the correct operating position without loosening the LHS control device, the operation brought by the LHS operation will be suspended and will not occur automatically, so as to protect the LHS operation safety.

LHS(Load Handling System)static control system

Various attachments

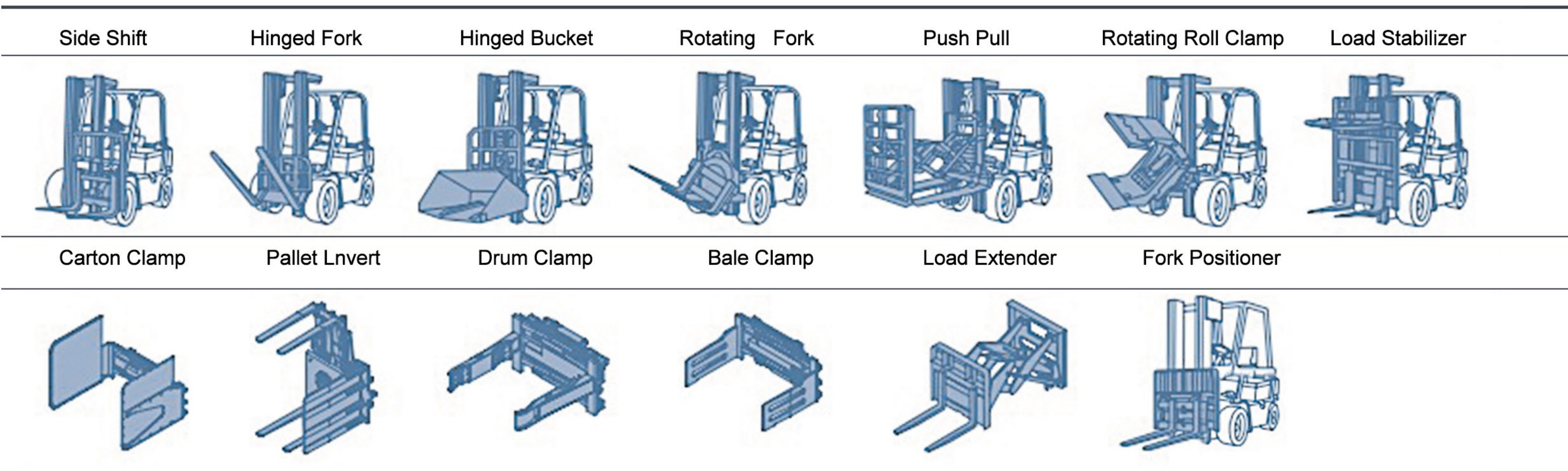

Standard equipment

- Awning
- Basic hand tool
- Anti-slip access step
- Air filter
- Hydraulic oil dipstick
- Traction device
- Lifting speed limit valve
- Full hydraulic power steering
- Wide view standard mast
- Standard forks
- Lift and tilt operating lever
- Adjustable of steering wheel
- Large rubber pedal pad
- Hand grip
- Waterproof cover on the OHG
- Multi-function control instrument
- Rear view mirror
- Fuel Gauge
- Pre-heating indicator
- Engine fuel pressure warning
- Neutral safety switch (hydraulic transmission)
- Standard overhead guard
- Transmission oil dipstick (hydraulic transmission)
- High-performance tires
- Standard backrest
- High-positioned air intake
- Hydraulic oil filter
- Self-lock valve of mast tilting
- Cable parking brake
- Front combined lamp
- Electrical horn
- Warning buzzer
- Hour meter
- Load safety valve
- Engine hood spring
- LED split rear taillight
- Charging indicator
- USB charging connectiong
- Klaxon
- Oil cooler (hydraulic transmission)
- Water temperature gauge
- Transmission oil temperature warning
- Standard seat
- Two-disc multiple valve
- Toolbox

Options

- Protection for tilt cylinder
- Front dual wheel
- Cabin
- High-mounted exhaust system
- Customized color
- Cabin heater
- Rear working light
- Dual air filter
- Net cover of radiator
- Solid tyre
- Middle-positioned exhausted system
- Exhaust fireproof device
- Suspension seat
- Purified exhaust system
- Warning lamp
- Extinguisher
- Copper water tank
- Rear armrest with horn button
- Counter weight net
- High and low overhead guard
- Fuel tank cap lock
- Weighing system
- Front/rear lights protective frame
- Neutral starting protection (mechanical transmission)
- Battery main switch
- Fan protector
- Speed limit alarm
- Wide view full free 2-stage mast
- Wide view full free 3-stage mast
- Wider fork carriage
- Special fork
- High-speed transmission



XINCHAI 3E22YG51



KUBOTA V2403 (Diesel)
KUBOTA WG2503 (GAS/LPG)



NISSAN GK21
NISSAN GK25

The whole machine adopts the engine conforming to the EU Stage V and the American environmental protection standard;

- The diesel engine adopts KUBOTA V2403 EU StageV and XINCHAI 3E22YG51 EU StageV electronic high pressure common rail engine and DOC + DPF tail gas treatment technology.
- Single/Dual fuel using KUBOTA WG2503 electronic high pressure common rail engine, using three catalytic tail gas treatment technology.

Note:DOC-Diesel Oxidation Catalyst

DPF-Diesel Particulate Filters

1.5-4.0T Diesel forklift engines / 1.0-4.0T GAS/LPG forklift engines

Capacity (Ton)	Manufacturer (Brand)	Engine Model	Drive Power	Code	Rated Power/Speed (kw/rpm)	Rated Torque/Speed (Nm/rpm)	Displacement (L)	Cylinder Qty. (Bore x Stroke)	Emission Standard
1.5-1.8	XINCHAI	N485BPG	Diesel	X1	30/2600	13/1820 ~ 2000	2.27	4-85×105	China Stage II
2-3.5	XINCHAI	C490BPG	Diesel	X2	40/2650	160/1800 ~ 2000	2.67	4-90×105	China Stage II
2-3.8	XINCHAI	A495BPG	Diesel	X3	42/2500	174/1800~2000	2.977	4-95×105	China Stage II
2-4	XINCHAI	A498BPG	Diesel	X4	45/2500	193/1800 ~ 2000	3.168	4-98×105	China Stage II
2-4	XINCHAI	4D29V41	Diesel	X5	36.8/2500	186/1600-1800	2.85	4-93x105	China Stage IV
2-4	XINCHAI	4D32V41	Diesel	X6	36.8/2500	190/1600-1800	3.17	4-98x105	China Stage IV
2-4	QUANCHAI	V29-50C43	Diesel	Q1	36.8/2500	190/1500~1850	2.85	4-93x105	China Stage IV
2-4	YANMAR	4TNE98-BQFLC	Diesel	Y1	42.1/2300	186/1700	3.319	4-98x110	Euro Stage IIIA
1.5-3.5	ISUZU	C240PKJ-30	Diesel	W1	35.4/2500	137.7/1800	2.369	4-86×102	Euro Stage IIIA
2-3.5	MITSUBISHI	S4S-DPEU2	Diesel	M1	35.3/2250	177/1700	3.331	4-94×120	Euro Stage IIIA
2-4	ISUZU	4JG2PE-01	Diesel	W2	46/2450	186/1700±100	3.059	4-95.4×107	Euro Stage IIIA
2-3.5	CUMMINS	QSF2.8t3NA49	Diesel	C1	36.5/2500	186/1100~1700	2.8	4-94×100	Euro Stage IIIA
2-4	CUMMINS	QSF2.8t3NA60	Diesel	C2	43/2500	186/1100~1500	2.8	4-94×100	Euro Stage IIIA
2-3.8	KOHLER	1903TCR	Diesel	L1	42/2600	225/1500	1.861	3-88×102	Euro Stage IIIB/EPA T4F
2-3.8	XINCHAI	3E22YG51	Diesel	X6	44.8/2400	210/1600~1800	2.23	3-94×107	Euro Stage V
2-3.8	KUBOTA	V2607-CR-EW03	Diesel	T1	37.4/2400	174.1/1500	2.615	4-87×110	Euro Stage V/EPA T4F
1.5-3.8	GUANGQING	GQ-4Y	Gas/LPG	G1	46/2800 (GAS) 39/2800 (LPG)	168/1800 (GAS) 156/1800 (LPG)	2.237	4-91×86	EURO II
1.5-2.5	NISSAN	GK21	Gas/LPG	N1	31.2/2250 (GAS) 29/2250 (LPG)	143.7/1600 (GAS) 143/1600 (LPG)	2.065	4-89×83	EPA T2
2-3.8	NISSAN	GK25	Gas/LPG	N2	37.4/2300 (GAS) 35/2300 (LPG)	176.5/1600 (GAS) 176/1600 (LPG)	2.488	4-89×100	EPA T2
2-4	PSI	PSI 2.4	Gas/LPG	P1	48/2700 (GAS) 46/2700 (LPG)	170/2400 (GAS) 168/1600 (LPG)	2.351	4-86.5×100	EPA T4
2-3.8	KUBOTA	WG2503-GL-3	Gas/LPG	T1	42.8/2600 (GAS) 43.5/2600 (LPG)	163.3/1800 (GAS) 173.7/1400 (LPG)	2.491	4-88×102.4	EPA T3 / Euro V

Special size of width and length can be made according to customer's requirement, All specifications and figures are subject to change without notice for improvement.