

SINOLIFT provides the best customer service and solutions. SINOLIFT is dedicated to providing you with the best and ultimate material handling solutions. SINOLIFT operate in an industry built on trust and guest satisfaction. This can only be achieved through communication and experienced support.

Model			EPT20K	EPT20K-Li
Power Type			AGM	LEP
Type of Operation			Pedestrian	Pedestrian
Load Capacity/Rated Load	q	kg	2000	2000
Load Center Distance	c	mm	600	600
Alex Centre to Fork Face	x	mm	948	948
Wheelbase	y	mm	1265	1265
Total Weight (with Battery)		kg	340	335
Tyre Type			Polyurethane	Polyurethane
Tyre Size (Load Wheel)		mm	φ80x60	φ80x60
Tyre Size (Drive Wheel)		mm	φ210x70	φ210x70
Tyre Size (Caster Wheel)		mm	φ70x36	φ230x75
Wheels Quantity, front/rear (x=Driving Wheels)			4/1x+2	4/1x+2
Track Width,Front,Driving Side		mm	520	520
Track Width,Rear,Loading Side		mm	400	400
Lifting Height	b10	mm	190	190
Height of Tiller Arm in Driving Position, Min.- Max.	b11	mm	950-1250	950-1250
Lowered Height	h3	mm	85	85
Overall Length	h14	mm	1620	1620
Length to Fork Face	h13	mm	460	460
Overall Width	l1	mm	680	680
Fork Dimension	l2	mm	54x160x1150(1220)	54x160x1150(1220)
Fork Spread Width	b1	mm	560/680	560/680
Ground Clearance at Center of Wheelbase (Min)	s/e/l	mm	27	27
Aisle Width for Pallets 1000x1200 Crossways	b5	mm	2415	2415
Aisle Width for Pallets 800x1200 Crossways	m2	mm	2315	2315
Turning Radius	Ast	mm	1430	1430
Traveling Speed (Laden/Unladen)	Ast	km/h	2.5/3	2.5/3
Lifting Speed (Laden/Unladen)	Wa	mm/s	35/45	35/45
Lowering Speed (Laden/Unladen)		mm/s	50/40	50/40
Max. Gradient Performance (Laden/Unladen)		%	5/8	5/8
Service Brake Type			Electromagnetic	Electromagnetic
Driving Motor Rating (DC) S2 60min		kw	0.75	0.75
Lifting Motor Rating S3 15%		kw	0.8	0.8
Battery Type			Acid	Li-ion
Battery Voltage/Capacity K5		V/Ah	24/100 (518*276*240mm)	48/30 (size:120*220*340mm)
Battery Weight		kg	54	50
Charger		V/A	24/15	48/10
Controller Model			DC	DC
Steering Type			Mechanical	Mechanical
Sound level atdriver's ear according to EN 12 053		dB	70	70

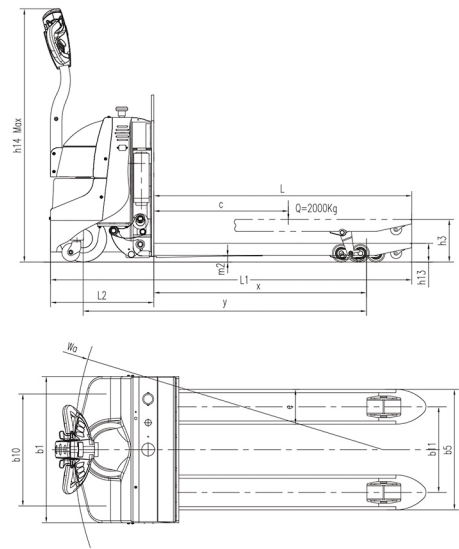

Standard Specification

- Polyurethane steer wheel and polyurethane load wheel
- Pallet entry/exit rollers
- Stability casters
- Vertically-mounted traction motor
- Lift motor
- Ergonomic operation with butterfly button
- Safety switch on tiller head.
- Horn
- Multi-function battery indicated (BDI)
- CAN-bus system
- Electric steering
- AGM battery or LEP battery
- Internal battery charger

Options

- Load backrest
- Cold store modification class III for environments down to -35°C
- Moisture resistance modification
- Equipment holder for: A4-size list bracket, computer rack, bottle holder and pen holder
- Large lift/lower levers
- Single load wheels
- Battery changing carousel
- Load backrest
- Tiller arm lock bypass
- Wide variety in fork lengths and fork widths
- Guide roller of pallet
- Explored proof devise (Ex)
- Scissors table loader

Special size of width and length can be made according to customer's requirement. All specifications and figures are subject to change without notice for improvement.



Easy Lift, Easy Life!

2000KG LOAD CAPACITY

4400LBS LOAD CAPACITY

Highly Maneuverable, Easily Serviceable, Broadly Flexible, Extremely Dependable

Designed to maneuver in and out of tight spaces, manufactured to deliver more productivity on every shift, built to last and equipped with ergonomic features that optimize operator comfort, visibility and efficiency — the EPT20K/EPT20K-Li combines amazing efficiency with the superior reliability you get from forklifts built by SINOLIFT.

- AC drive motor requires virtually no maintenance.
- Two 24-volt sealed lead-acid batteries or Lithium-Ion battery do not require watering.
- Entry and exit rollers allow for easy entering and exiting of pallets .
- High ground clearance for working around transitions and uneven surfaces.
- Polyurethane drive tires for low noise.
- Built-in charger with easily accessible charging cord.





Italian ZAPI or American CURTIS solid state controllers provide smooth acceleration and seamless directional control. Its regenerative braking feature adds energy back to the battery to improve efficiency.

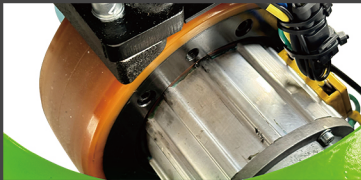

Powerful and reliable AC traction motors, able to satisfy even the most demanding requests for performance, providing the necessary amount of power every time, as the speed of the truck can be adjusted by changing the position of the throttle.



Made of bended sheet metal to minimize any tensions induced by welds, ensuring maximum mechanical resistance over time. The battery compartment can be easily opened by lifting the cover, simplifying the daily and periodical battery recharge and check operations. Particular attention has been paid to provide easy access to wear parts, minimizing therefore the routine maintenance costs. The forks are made of high strength steel. The frame has been painted using cutting edge equipment.



Result of a meticulous ergonomic study that combines operating comfort with modern industrial design. The tiller is fitted with easy to reach controls, ensuring enhanced productivity, precision and efficiency. When released, the tiller returns smoothly to its vertical position thanks to the gas spring fitted with slowdown limit switch.

The SINOLIFT electric walkie pallet truck EPT20K/EPT20K-Li combines ergonomic features and reliable performance with energy efficient technology. The low-maintenance helps increase productivity and reduce operational costs.

MAXIMUM MANEUVERABILITY

In and out of trailers, up and down tight aisles, over dock plates and ramp angles, every aspect of the EPT20K/EPT20K-Li were designed to provide maximum performance in minimal space. No other walkie offers such a tight turning radius, a higher lift height - or the capability to maneuver so quickly, confidently, effortlessly and productively in tight spaces.

PRODUCTIVITY

- Advanced AC control system eliminates the motor brushes, which limits maintenance requirements.
- Low skirting on main chassis.
- Side battery roll-out system is very convenient to replace batteries.
- Built-in pressure relief valve protects the trucks from overloading.
- Emergency power disconnect switch.
- Long handle reduces steering effort.
- Emergency reversing system in handle.
- Low speed switch in the handle.
- Variable speed control.
- Cold store configuration (option).

OPTIMUM STRUCTURAL DESIGN

- Spring-loaded casters improve lateral stability on uneven floors and enhance truck performance and service life.
- Formed heavy gauge steel provides maximum fork strength and longevity.
- Pull rod design protects against bending.
- Durable plastic covers.

SERVICEABILITY

- CANbus technology reduces wiring complexity.
- Low battery protection setting extends the battery life.
- All pivot points have grease fittings and serviceable bushing, reducing component wear.

ROBUST TRUCKS
FOR HIGH PRODUCTIVITY

More accurate operation mechanism;
Moving parts hard-wearing;
More stable travelling procedure;
More convenient for maintenance.

Ergonomic Handle

Reduces operator's fatigue



Poly Drive Tire

Provides longer tire and has lower energy consumption versus a rubber tire

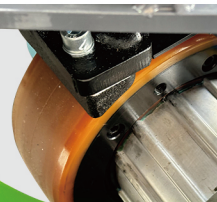

Hour Meter/BDI

Keeps track of hours used and reserves battery power at a glance



Emergency button

Emergency switch located where you can easily reach and control, assuring safety for people and truck



One-piece High Tensile Steel Forks

Are formed into a C-channel and reinforced in critical areas

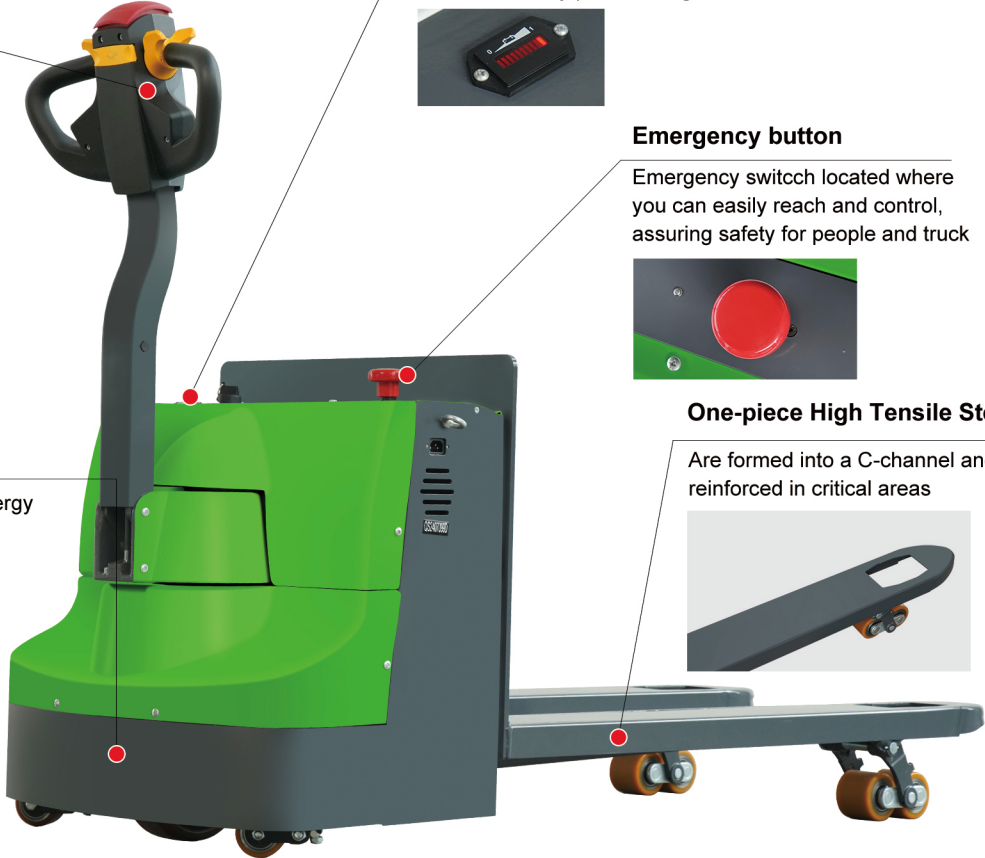

Ergonomic multifunction handle control can be equipped with push button functions, emergency safety reversing and large central horn button for safe operation.



Fork construction and pallet entry slides allow easy pallet entry by lifting the fork up and over bottom board.



Display provides hour meter, battery lift, and system trouble code tracking for ease of service. The control panel also includes a power key switch and emergency stop button.



Hydraulic overload protection to prevent operator's from lifting loads greater than the rated capacity. Self-contained hydraulic systems provide less space and superior strength for lighter load.



24-volt electrical system delivers efficient power for maximum work performance and run time — providing longer work cycles, reducing downtime and delivering more productivity.



Amazing reliability and energy efficiency are the hallmarks of our heavy-duty, high-output 0.75kW DC drive motor. It's vertically mounted to eliminate cable flexing and delivers high starting torque and plenty of power.